

blueprinter®

How to Re-Use BluePrinter powder

How to re-use BluePrinter powder

1. When a print is finalized – the powder from the containers A+B must be filtered

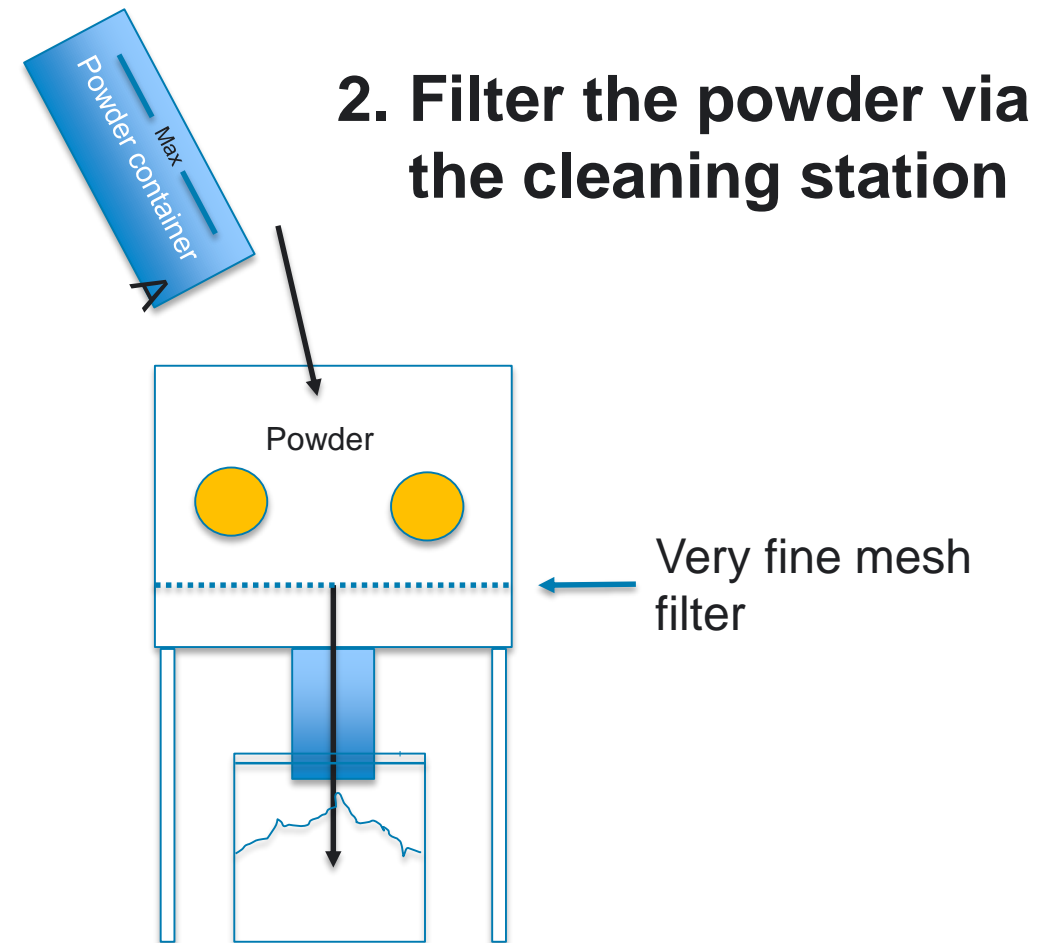
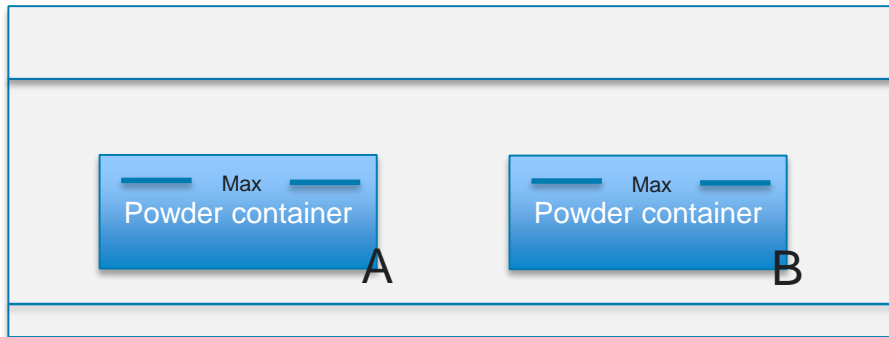

Prepare re-use powder

- Use the white bucket supplied by BluePrinter to collect the powder from the cleaning station

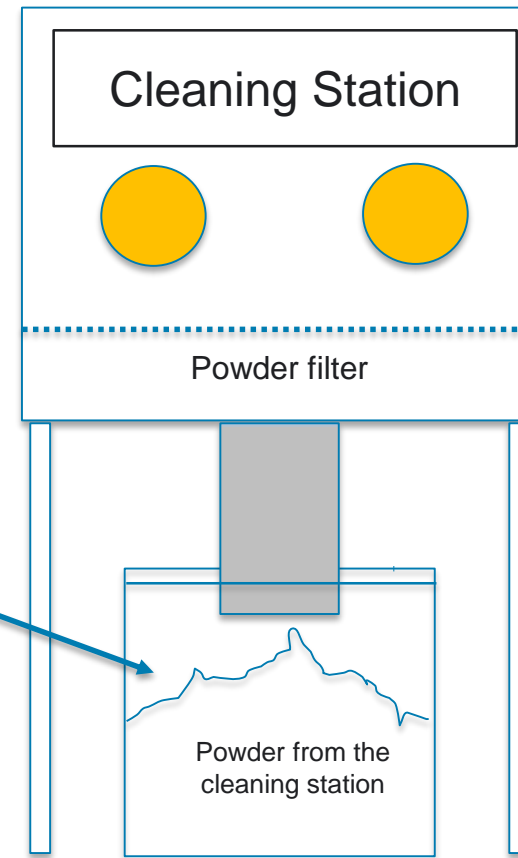

Load printer with powder

1. Load powder into container A
2. Prepare a second re-use drum and load container B

